

# FE-LP

## STRETCH WRAPPING MACHINES

STRETCH WRAPPING FOR PALLET  
LOADS OF RANDOM HEIGHTS

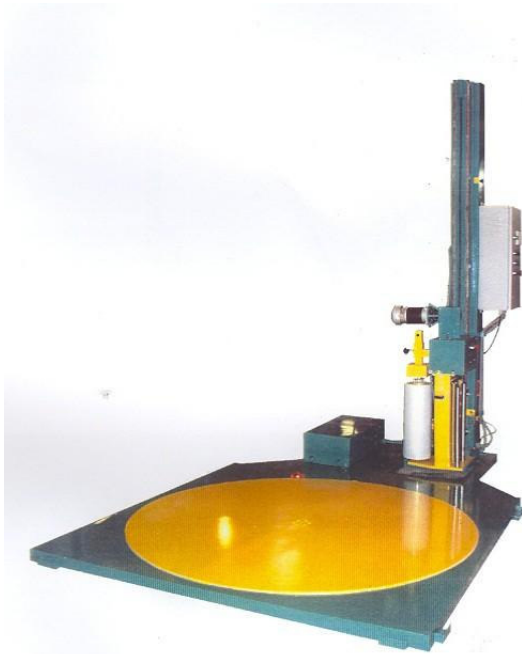

### STRETCH WRAP UP TO 25 LOADS -PER HOUR

The FE-LP machines handle random height loads weighing up to 2000 kgs. Each. Custom designed machines are also available for different loads sizes.

### EASY TO USE

Operation of the machine is simple. All the operator has to do is attach the film to the load and press, "CYCLE ON" on control panel. The machine automatically applies the preset number of bottom and top wraps in addition to the spiral wraps. After wrap cycle is complete, the elevator and turntable return to home position. The operator then cuts the film and brushes the film tail on the load. The machine is now ready for the next load.

### ACCU-STRETCH FOR FILM ECONOMY

- 0-300% variable pre stretch ensures minimum cost of consumable, while maintaining optimum load integrity.
- ACCU-STRETCH-II powered pre stretch offers superior economy with proven reliability.
- Film stretch occurs between two powered, textured rollers, which ensure even stretch with a minimum of neck-down (reduction in width)
- Independent film tension adjustment to enable wrapping of light and delicate loads with less tension and heavier loads with more tension.

### VARIABLE SPEED TURNTABLE FOR 'SOFT START

Gradual acceleration and deceleration of the turntable greatly reduces the chance of load displacement during the wrap cycle. This is a standard feature on FE Series.

### AUTOMATIC LOAD HEIGHT SENSING

These machines are fitted with photo eye sensing option to sense the height of the load automatically. For constant height operation, proximity sensor option can be adopted.

### CONTROL PANEL FUNCTIONS

- Wrap selection switch for selection of bottom and top wrap count
- Illuminated bulbs for indication of "Machine on" and Home position
- Auto/Manual for selection of mode in which machine has to run
- Elevator up and turntable inching push buttons are provided for operating elevator and turntable individually in manual mode.
- Pause switch for stopping the operation temporarily in between the cycle
- Emergency stop to cancel the cycle in between the operation
- Display of stretch film percentage and weight of film consumed
- Electric eye toggles switch turns the electric eye on and senses the height of the object automatically
- Reinforcement push button holds elevator in position during cycle

## OPTIONS

FE-LP is also available with the following options:

1. Electrically actuated top platen attachment for lighter loads.
2. Variable position loading ramp, ramp extensions
3. Dual turntable configuration.

## APPLICATION

Both palletized and non palletized loads can be wrapped.

Some of the typical applications include all export palletized cargo, bulk unitization of Yarn, POY, PFY, Plastic moulded products, Glass bottles/Pet bottles etc.

## CONTROL PANEL PHOTO



Internal speed controls for turntable and elevator \* Modular components for easy replacement, if necessary

## SPECIFICATIONS

### PERFORMANCE

Turntable speed	: Variable up to 9 RPM
Loads per hour	: Up to 25 max
Min. wrap height	: Turntable surface
Max. wrap height	: 2400mm
	: 2700mm optional height available

### LOAD CAPABILITIES

Max. load size	: 1290 mm x 1290 mm
Max. load height	: 2400 mm
Max. load diagonal	: 1830 mm
Max. load weight	: 2000 kgs (Centered)

### FILM DELIVER SYSTEM

Type	: Powered prestretch
Film stretch	: Adjustable up to 300%
Film roll diameter	: 254 mm (10")
Film roll width	: 508 mm (20")
Core size	: 76.2 mm
Min. film tension	: 0.5 kgs (approximate)
Powered prestretch motor	: ½ HP, 180V PMDC

### ELECTRICAL

Power requirements	: 220V AC, Single phase, 2 kw
Controller type	: Dedicated PLC
Turntable motor	: 1 HP, 180V PMDC
Film elevator motor	: ½ HP, 180V PMDC

### MECHANICAL

Shipping weight	: 1150 kgs (approx.)
Main Drive type	: Chain & Sprocket
Construction	: Structural steel plates and tubes

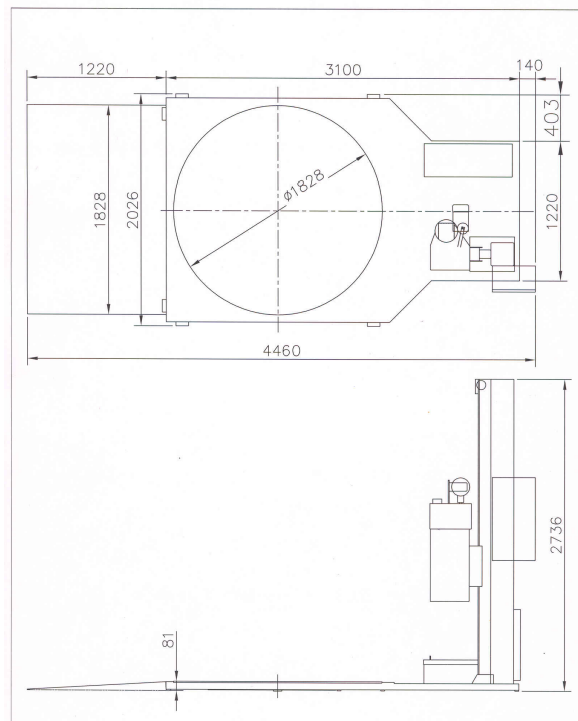

All dimensions approximate. The company has policy of continuous product development and reserves a right to alter specifications without prior notice